

4

3

2

1

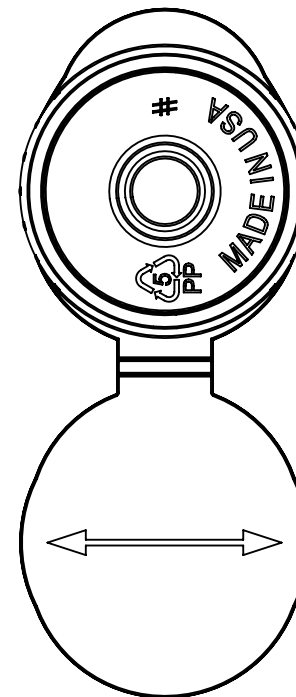
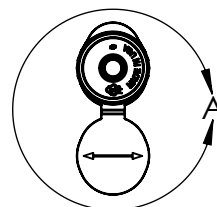
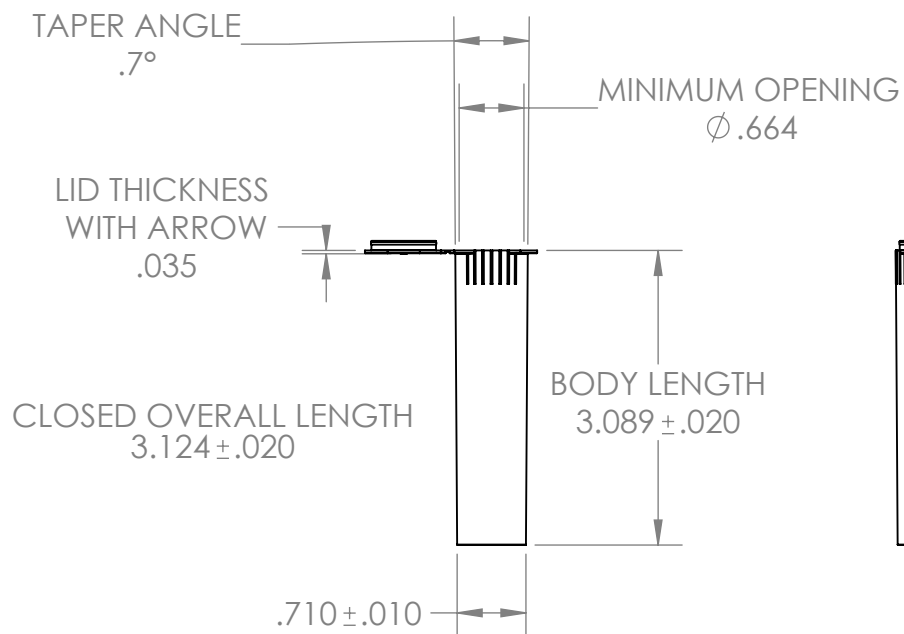

DETAIL A
SCALE 2 : 1

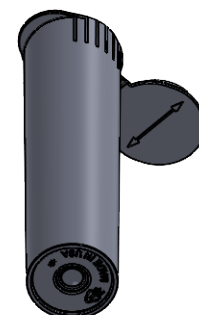
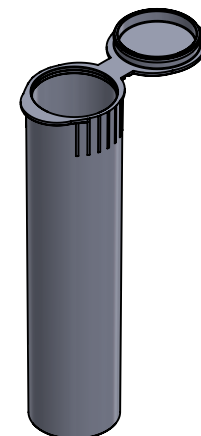

NOTES:

1. REV3.1
2. MIN. HINGE LIFE: 25 CYCLES
3. OPENING FORCE: 18-35 LBS
4. COLOR MATCHING BATCH TO BATCH USING HUNTER L+/-1.5, A+/-1.0, B+/-1.0
5. MAX. FLASH ALLOWED: 0.050IN
6. COSMETIC EXEMPTIONS: MINIMAL SCRATCHING AND SCUFFING ALLOWED BUT MAY OCCUR FROM VARYING SHIPPING AND FRIEGHT CONDITIONS



INTERTECH

PART NAME

78mm Tube

SIZE

A

STANDARD MATERIAL
POLYPROPYLENE (PP)

STANDARD WEIGHT
4.5 ± .2 GMS

DIMENSIONS ARE IN INCHES

DO NOT SCALE

SCALE: 1:2

SHEET 1 OF 1

4

3

2

1