

4

3

2

1

D

D

C

C

B

B

A

A

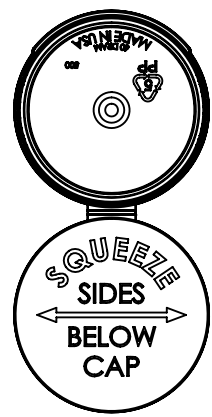
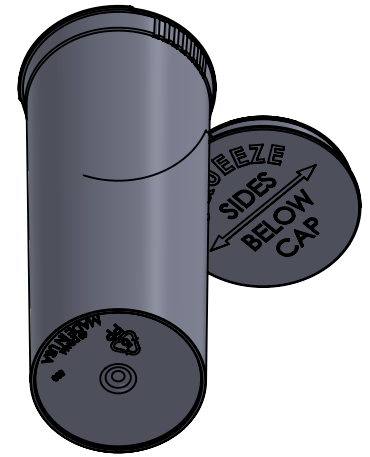
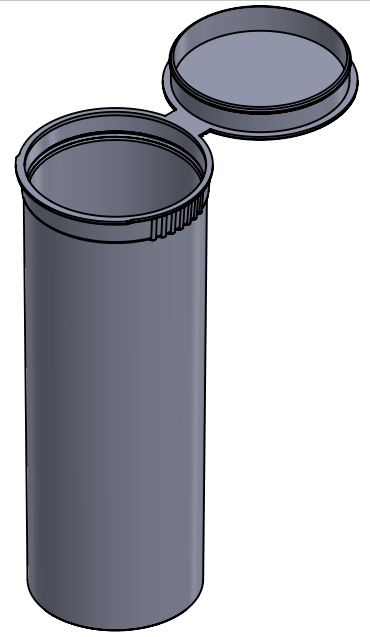
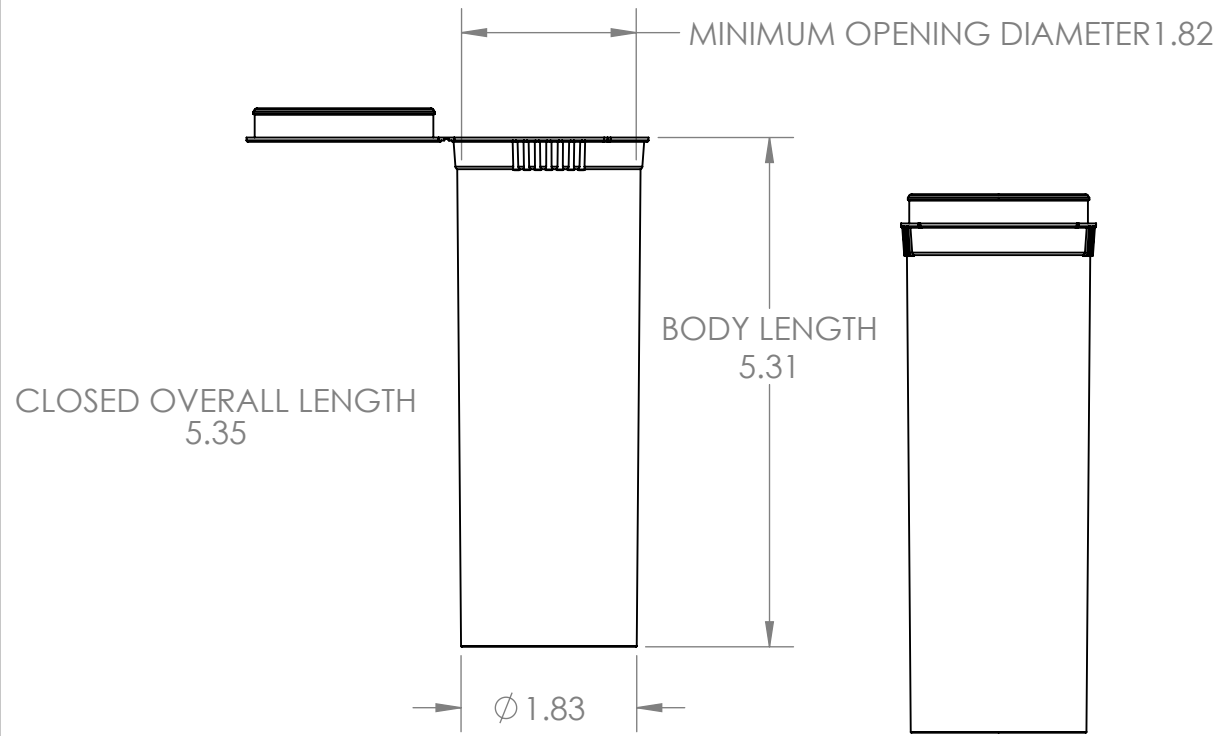

- NOTES:
1. REV 1.1
 2. MIN. HINGE LIFE: 25 CYCLES
 3. OPENING FORCE: 18-35 LBS
 4. COLOR MATCHING BATCH TO BATCH USING HUNTER L+/-1.5, A+/-1.0, B+/-1.0
 5. MAX. FLASH ALLOWED: 0.050IN
 6. COSMETIC EXEMPTIONS: MINIMAL SCRATCHING, SCUFFING ALLOWED BUT MAY OCCUR FROM VARYING SHIPPING AND FRIEGHT CONDITIONS



PART NAME
60 DRAM

SIZE A	STANDARD MATERIAL POLYPROPYLENE (PP)	STANDARD WEIGHT 24.1 GMS
DIMENSIONS ARE IN INCHES		
DO NOT SCALE	SCALE: 1:1	SHEET 1 OF 1

4

3

2

1