

4

3

2

1

D

D

C

C

B

B

A

A

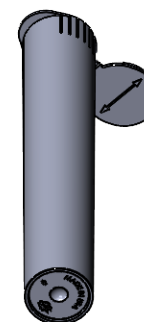
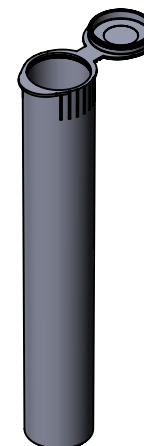
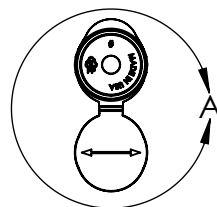
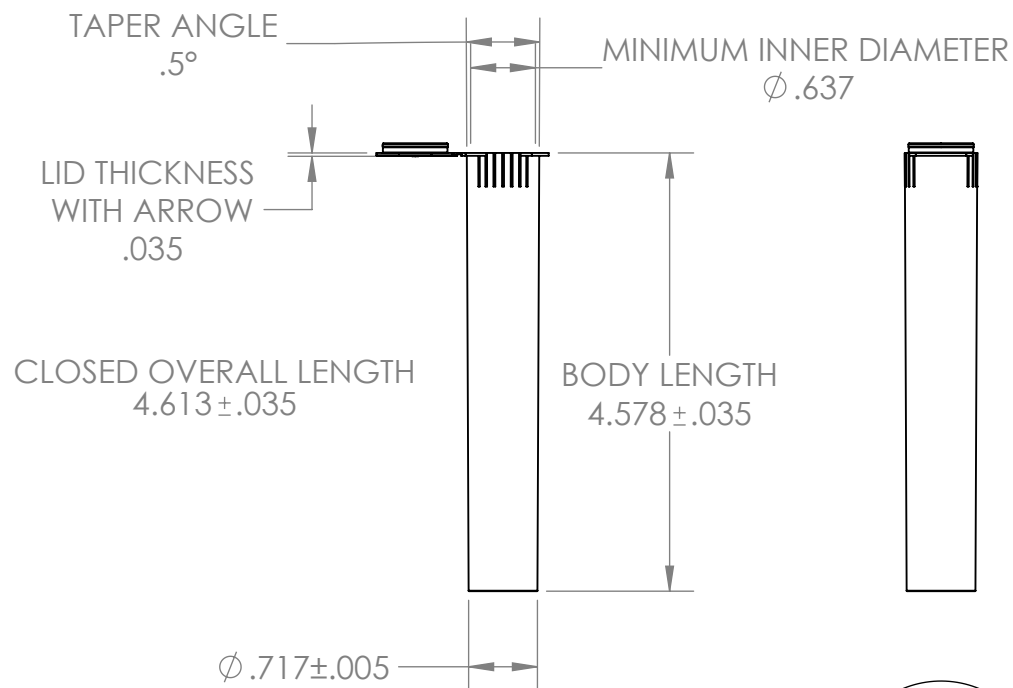

NOTES:

1. REV3.1
2. MIN. HINGE LIFE: 25 CYCLES
3. OPENING FORCE: 18-35 LBS
4. COLOR MATCHING BATCH TO BATCH USING HUNTER L+/-1.5, A+/-1.0, B+/-1.0
5. MAX. FLASH ALLOWED: 0.050IN
6. COSMETIC EXEMPTIONS: MINIMAL SCRATCHING AND SCUFFING ALLOWED BUT MAY OCCUR FROM VARYING SHIPPING AND FRIEGHT CONDITIONS

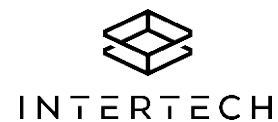

PART NAME

116mm Tube

| SIZE | STANDARD MATERIAL | STANDARD WEIGHT |
|--------------|--------------------|-----------------|
| A | POLYPROPYLENE (PP) | 6.5±.2 GMS |
| DO NOT SCALE | SCALE: 1:2 | SHEET 1 OF 1 |

DIMENSIONS ARE IN INCHES

4

3

2

1